

# DC24-12

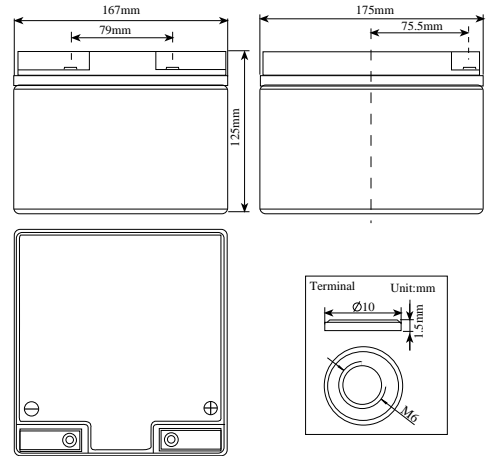

## Specifications

Nominal Voltage	12V	
Rated Capacity(20 hour rate)	24AH	
Dimension	Total Height (with terminals)	125mm(4.92inches)
	Height	125mm(4.92inches)
	Length	167mm(6.57inches)
	Width	175mm(6.89inches)
Weight	Approx.8.9kg(19.62lbs)	

## Characteristics

Capacity 77°F(25°C)	20 hour rate(1.2A)	24AH
	10 hour rate(2.16A)	21.6AH
	5 hour rate(3.94A)	19.7AH
	1 hour rate(13.9A)	13.9AH
Internal Resistance	Full charged Battery 77°F(25°C)	10mΩ
Capacity affected by Temperature (20 hour rate)	104°F(40°C)	102%
	77°F(25°C)	100%
	32°F(0°C)	85%
	5°F(-15°C)	65%
Self-Discharge 77°F(25°C)	Capacity after 3 month storage	91%
	Capacity after 6 month storage	82%
	Capacity after 12 month storage	64%
Max. Discharge Current 77°F(25°C)	360A(5S)	
Terminal	Standard	F14
	Optional	
Charging (Constant Voltage)	Cycle	Initial Charging Current 4.8A Or Small 14.5V~14.9V/77°F(25°C)
	Float	13.6V~13.8V/77°F(25°C)

## Discharge characteristics 77°F(25°C)

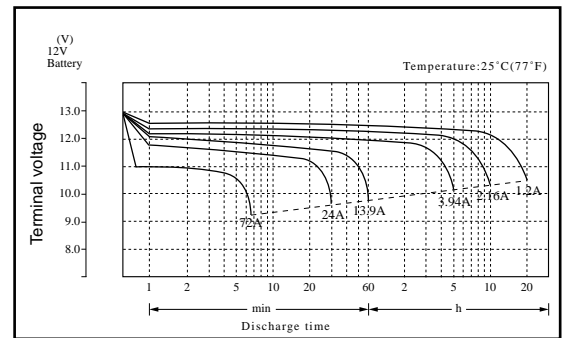

## Duration of discharge vs. Discharge current

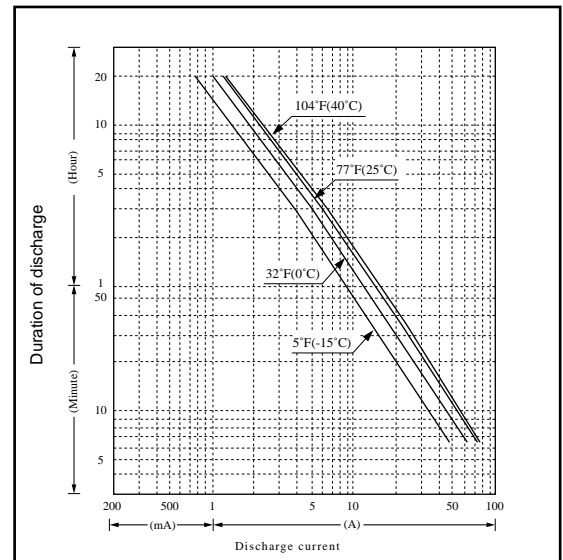

## Constant Power Discharge Watts Per Cell @ 77°F(25°C)

Cut off voltageV/cell	5M	10M	15M	30M	45M	1H	2H	3H	5H	8H	10H	12H	24H
1.60	168	108	84.3	49.2	37.7	33.1	19.4	13.9	9.21	5.64	4.46	3.94	2.01
1.67	167	107	83.4	48.5	37.1	32.4	19.0	13.7	9.21	5.64	4.46	3.94	2.01
1.70	165	106	82.9	48.1	36.8	32.1	18.7	13.4	9.21	5.64	4.46	3.94	2.01
1.75	162	105	82.5	47.5	36.2	31.5	18.3	13.1	9.21	5.64	4.46	3.94	2.01
1.80	161	104	81.3	46.8	35.5	30.8	17.9	13.0	9.11	5.54	4.46	3.94	2.01
1.85	160	103	80.0	45.9	34.6	30.0	17.4	12.6	8.91	5.45	4.36	3.92	2.01

**Note** The above data are average values, and can be obtained within 3 charge/discharge cycles. These are not minimum values.