

DC100-12B

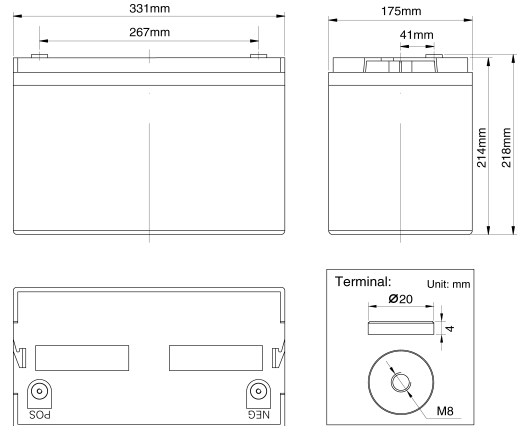

Specifications

| | | |
|------------------------------|-------------------------------|--------------------|
| Nominal Voltage | 12V | |
| Rated Capacity(20 hour rate) | 100AH | |
| Dimension | Total Height (with terminals) | 218mm(8.59inches) |
| | Height | 214mm(8.43inches) |
| | Length | 331mm(13.03inches) |
| | Width | 175mm(6.89inches) |
| Weight | Approx.34.3kg(75.62lbs) | |

Discharge characteristics 77°F(25°C)

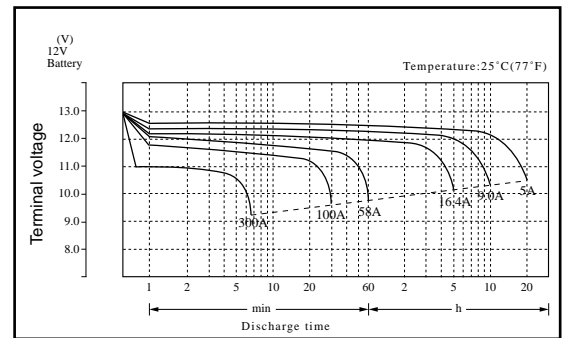

Characteristics

| | | |
|---|---------------------------------|---|
| Capacity 77°F(25°C) | 20 hour rate(5A) | 100AH |
| | 10 hour rate(9.0A) | 90AH |
| | 5 hour rate(16.4A) | 82AH |
| | 1 hour rate(58A) | 58AH |
| Internal Resistance | Full charged Battery 77°F(25°C) | 3.5mΩ |
| Capacity affected by Temperature (20 hour rate) | 104°F(40°C) | 102% |
| | 77°F(25°C) | 100% |
| | 32°F(0°C) | 85% |
| | 5°F(-15°C) | 65% |
| Self-Discharge 77°F(25°C) | Capacity after 3 month storage | 91% |
| | Capacity after 6 month storage | 82% |
| | Capacity after 12 month storage | 64% |
| Max. Discharge Current 77°F(25°C) | 1500A(5S) | |
| Terminal | Standard | F17 |
| | Optional | F11 |
| Charging (Constant Voltage) | Cycle | Initial Charging Current 20A Or Small 14.5V~14.9V/77°F(25°C) |
| | Float | 13.6V~13.8V/77°F(25°C) |

Duration of discharge vs. Discharge current

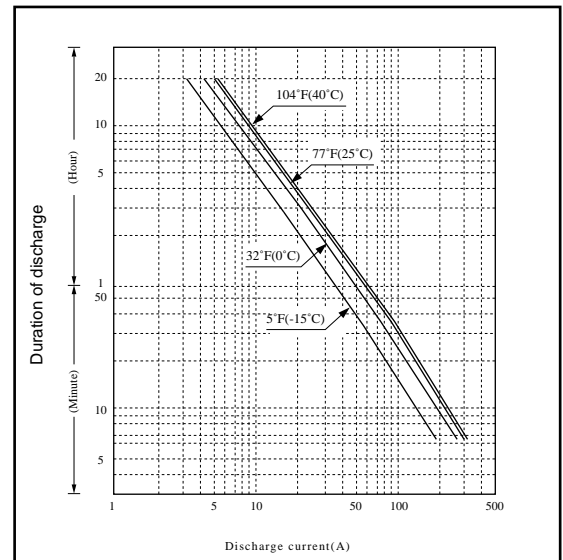

Constant Power Discharge Watts Per Cell @ 77°F(25°C)

| Cut off voltageV/cell | 5M | 10M | 15M | 30M | 45M | 1H | 2H | 3H | 5H | 8H | 10H | 12H | 24H |
|-----------------------|-----|-----|-----|-----|-----|-----|------|------|------|------|------|------|------|
| 1.60 | 628 | 459 | 367 | 223 | 160 | 125 | 73.7 | 51.4 | 34.8 | 23.0 | 19.4 | 16.8 | 8.70 |
| 1.65 | 616 | 454 | 362 | 221 | 158 | 124 | 74.1 | 51.0 | 34.8 | 23.0 | 19.4 | 16.8 | 8.70 |
| 1.67 | 608 | 449 | 357 | 219 | 157 | 123 | 73.7 | 50.6 | 34.8 | 23.0 | 19.4 | 16.8 | 8.70 |
| 1.70 | 588 | 434 | 343 | 214 | 153 | 122 | 73.4 | 50.2 | 34.8 | 23.0 | 19.4 | 16.8 | 8.70 |
| 1.75 | 562 | 415 | 328 | 205 | 149 | 120 | 72.8 | 49.6 | 34.4 | 22.6 | 19.2 | 16.8 | 8.70 |
| 1.80 | 536 | 397 | 313 | 197 | 145 | 118 | 72.1 | 49.0 | 33.9 | 22.2 | 18.8 | 16.5 | 8.70 |

Note The above data are average values, and can be obtained within 3 charge/discharge cycles. These are not minimum values.